

# Rounthwaite **R&W** Woodhead

53 MARKET PLACE, MALTON, NORTH YORKSHIRE, YO17 7LX Tel: (01653) 600747



**MULBERRY HOUSE NORTH GARTH LANE, SHERIFF HUTTON, YO60 6SF**

**GENERAL INFORMATION:**

**£1,450 PER MONTH**

Also at: 26 Market Place, Kirkbymoorside Tel: (01751) 430034 & Market Place, Pickering Tel: (01751) 472800

Email: [malton@rounthwaite-woodhead.co.uk](mailto:malton@rounthwaite-woodhead.co.uk) [www.rounthwaite-woodhead.com](http://www.rounthwaite-woodhead.com)

## Description

A well-presented four-bedroom detached home enjoying a lovely outlook towards the Howardian Hills. The property offers a modern kitchen with integrated oven & electric hob, separate dining room, and a sitting room with an open fire. Additional ground floor features include a utility room and a shower room/WC.

Upstairs are four bedrooms and a house bathroom (Master with dressing room).

Outside the property has an enclosed South facing garden with a patio for sitting out and a useful timber shed. There is parking to the front along with an integral garage.

Sheriff Hutton is a charming and desirable village about 10 miles North of York City centre to the edge of the stunning Howardian Hills and just a short drive to Castle Howard. The village has a wealth of amenities including a Public House, a post office & village shop, a village hall with sports facilities and a highly regarded Primary School. The 14th Century Castle ruins are also of particular appeal.

## General Information



## Accommodation

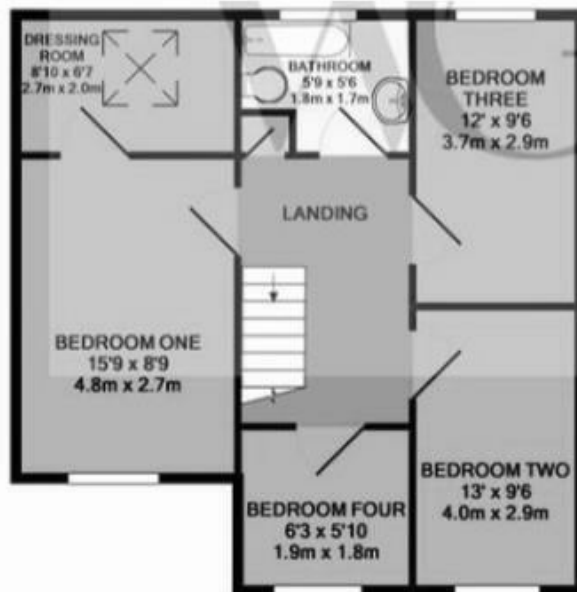

### Energy Efficiency Rating

	Current	Potential
Very energy efficient - lower running costs		
(92 plus) <b>A</b>		
(81-91) <b>B</b>		
(69-80) <b>C</b>		
(55-68) <b>D</b>		
(39-54) <b>E</b>		
(21-38) <b>F</b>		
(1-20) <b>G</b>		
Not energy efficient - higher running costs		
	57	69
England & Wales		
EU Directive 2002/91/EC		

### Environmental Impact (CO<sub>2</sub>) Rating

	Current	Potential
Very environmentally friendly - lower CO <sub>2</sub> emissions		
(92 plus) <b>A</b>		
(81-91) <b>B</b>		
(69-80) <b>C</b>		
(55-68) <b>D</b>		
(39-54) <b>E</b>		
(21-38) <b>F</b>		
(1-20) <b>G</b>		
Not environmentally friendly - higher CO <sub>2</sub> emissions		
England & Wales		
EU Directive 2002/91/EC		





Messrs Rounthwaite & Woodhead for themselves and their vendors and lessors whose agents they are give notice that these particulars are produced in good faith, set out as a general guide only and do not constitute any part of a contract. No person employed by Messrs Rounthwaite & Woodhead has any authority to make or give any representation or warranty whatsoever in relation to this property. The dimensions in the sales particulars are approximate only and the accuracy of any description cannot be guaranteed. Reference to machinery, services and electrical goods does not indicate that they are in good or working order. All reference to prices and rents etc. exclude VAT which may apply in some cases.

Covering Ryedale through offices in Malton, Pickering and Kirkbymoorside  
[www.rounthwaite-woodhead.com](http://www.rounthwaite-woodhead.com)

Rounthwaite **R&W** Woodhead